

ULTRASPAN TONGUE & GROOVE PVC TWIN WALL SECRET FIX PLANK FOR WALL AND CEILINGS. FOOD SAFE, CLASS 1 SURFACE SPREAD OF FLAME.

REDUCES CONDENSATION UP TO 75%, WHEN USED ON CEILING APPLICATIONS. WATERTIGHT ON VERTICAL FIXING.

ULTRASPAN 407mm WIDE X 10mm THICK AND VARIOUS LENGTH FROM 2.4m UP TO 6m. ALTERNATIVE PANEL SIZE INCLUDES 250mm WIDE X 10mm THICK.

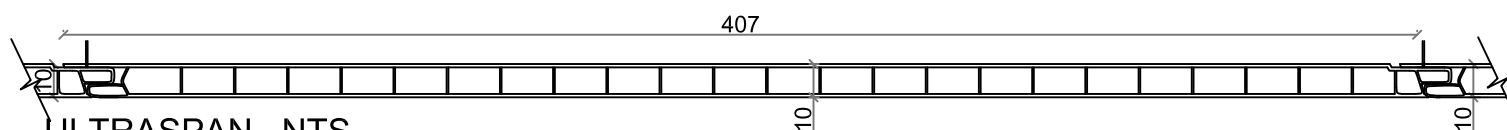

ULTRASPAN NTS
 KKULTRA407 - 407mm X 10mm

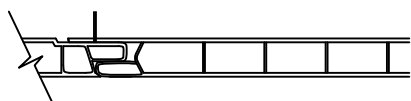

HIDDEN FIXING
 DETAIL 1:2

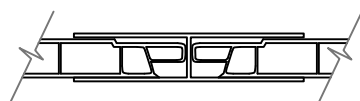

ULTRASPAN JOINTING
 PROFILE 1:2
 HD10 - 10mm



ULTRASPAN START &
 EDGE PROFILE 1:2
 ET10 - 10mm

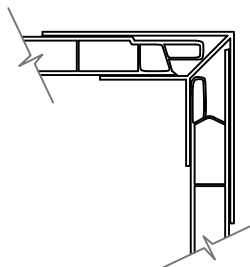

INTERNAL CORNER
 PROFILE 1:2

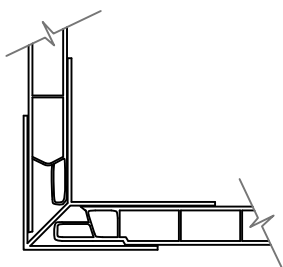

EXTERNAL CORNER
 PROFILE 1:2



BASE TRACK
 PROFILE 1:2
 ET10 - 10mm

NOTES

ULTRASPAN IS AN EXTRUDED PVC VERTICAL FIXING PANEL, WHICH CAN BE USED IN VARIOUS APPLICATIONS, ESPECIALLY SHOWERS, FOOD SAFE AREAS AND CEILINGS, WHERE THE ULTRASPAN PANEL CAN REDUCE CONDENSATION ON A CEILING UP TO 75%. ULTRASPAN COMES IN 407mm WIDE X 10mm THICK or 250mm WIDE X 10mm THICK AND VARIOUS LENGTHS FROM 2.4m UP TO 6m. THE ULTRASPAN BOARD CAN BE USED EXTERNALLY DUE TO THE DUAL WALL REINFORCED LIP TONGUE DETAIL. THE VERTICAL FIXING GIVES A WATER TIGHT CONNECTION AND IS SUITABLE FOR CARWASH APPLICATIONS OR WHERE A WATERTIGHT FINISH IS REQUIRED. SECRET FIXING THROUGH BACK OF TONGUE. WHITE IS THE STANDARD PANEL COLOUR, HOWEVER THE PANELS ARE AVAILABLE IN NETWORK RAIL GREY AND TESCO BLUE, WITH CORPORATE COLOURS AVAILABLE UPON REQUEST. PRINTED IMAGES, LOGOS AND VINYL PRINTED IMAGES CAN BE APPLIED.

CLEANING STRATEGY FOR O&M MANUALS SEE CSO&M DATA SHEET.

NBS Ref: Q40/430